



**Electrolux**  
PROFESSIONAL

**Modular Cooking Range Line**  
**thermaline 80 - 700 mm Passthrough**  
**open base, GN conform, 2 Sides (H2) -**  
**H=550**

ITEM # \_\_\_\_\_

MODEL # \_\_\_\_\_

NAME # \_\_\_\_\_

SIS # \_\_\_\_\_

AIA # \_\_\_\_\_



**588229 (MA2BDCGOOO)**

Passthrough open base,  
two-side operated, GN - H2

### Short Form Specification

**Item No.** \_\_\_\_\_

700 mm wide open passthrough base compartment to store pots, pans, sheet pans, etc. with hygienic design and round edges. Unit constructed according to DIN 18860\_2 with 70 mm recessed plinth. Internal frame for heavy duty sturdiness in 2 mm and 3 mm in 1.

### Main Features

- All major components may be easily accessed from the front.
- Unit to be placed below modular top appliances to store pots, pans, sheet pans, etc.

### Construction

- IPX5 water resistance certification.
- Hygienic design of the open base compartment with large round edges.
- 2 mm top in 1.4301 (AISI 304).
- Flat surface construction with minimal hidden areas to easily clean all surfaces
- Storage space in the base of the appliance that can accept GN1/1 containers.
- Internal frame for heavy duty sturdiness in stainless steel.

**APPROVAL:** \_\_\_\_\_



Experience the Excellence  
[www.electroluxprofessional.com](http://www.electroluxprofessional.com)



**Electrolux**  
PROFESSIONAL

**Modular Cooking Range Line**  
**thermaline 80 - 700 mm Passthrough open**  
**base, GN conform, 2 Sides (H2) - H=550**

Front

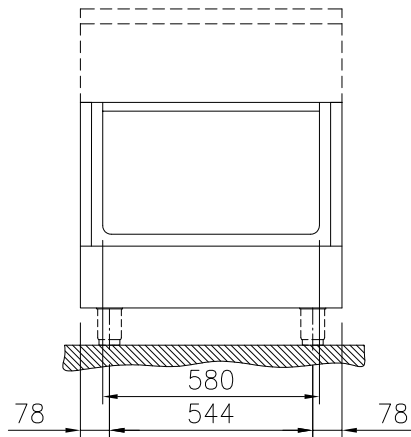

Side

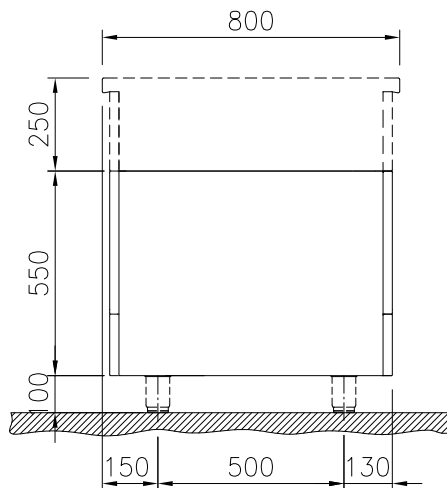

Top

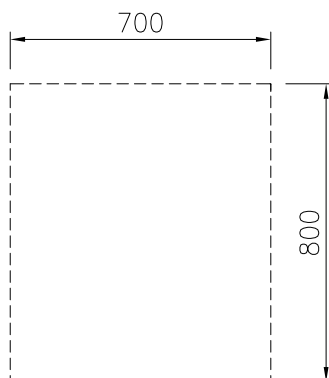

**Key Information:**

External dimensions, Width:	
588229 (MA2BDCGOOO)	700 mm
External dimensions, Depth:	800 mm
External dimensions, Height:	550 mm
Cupboard Cavity Dimensions (width):	580 mm
Cupboard Cavity Dimensions (height):	330 mm
Cupboard Cavity Dimensions (depth):	760 mm
Net weight:	21 kg



**Modular Cooking Range Line**  
**thermaline 80 - 700 mm Passthrough open base, GN conform, 2 Sides**  
**(H2) - H=550**  
The company reserves the right to make modifications to the products  
without prior notice. All information correct at time of printing.

2025.12.12



**Electrolux**  
PROFESSIONAL

**Modular Cooking Range Line**  
**thermaline 80 - 700 mm Passthrough open**  
**base, GN conform, 2 Sides (H2) - H=550**

### Optional Accessories

- Stainless steel side panel (12mm), 800x800mm, freestanding PNC 912508 ☐
- Stainless steel front kicking strip, 700mm width PNC 912597 ☐
- Stainless steel side kicking strips left and right, freestanding, 800mm width PNC 912619 ☐
- Stainless steel plinth, freestanding, 700mm width PNC 912824 ☐
- - NOT TRANSLATED - PNC 913234 ☐
- - NOT TRANSLATED - PNC 913257 ☐
- - NOT TRANSLATED - PNC 913281 ☐
- - NOT TRANSLATED - PNC 913669 ☐
- - NOT TRANSLATED - PNC 913685 ☐



**Modular Cooking Range Line**  
**thermaline 80 - 700 mm Passthrough open base, GN conform, 2 Sides**  
**(H2) - H=550**  
The company reserves the right to make modifications to the products  
without prior notice. All information correct at time of printing.

2025.12.12